

## PEABODY HALL

Peabody Hall is served by a combination of 10 Single Zone, Constant Volume Air Handling Units (4 pipe) and 8 Fan Coil Units spread across three floors of the building. Cooling is provided by chilled water imported from the North Campus Chilled Water District. Heating is provided by hot water generated in the building via a steam to water heat exchanger, using steam from the Campus Central Steam Plant.

AIR HANDLING UNITS (AHUs)- The single zone, air handling units deliver a constant volume of either heated, or cooled air consisting of a mixture of recirculated building air or fresh air from outside of the building. The building return air is filtered, mixed with outdoor air and cooled or heated with chilled water coils and hot water coils in each of the 10 building air handling units before being supplied to rooms throughout the building through above ceiling ductwork. There are generally between 4 and 10 rooms served by each AHU in Peabody Hall, with the exception of the main auditorium which is served by two AHUs.

Air is recirculated from the spaces back to the air handling units through ceiling mounted air return registers located in each space. Return air is pulled from a plenum space above the ceiling, in lieu of ductwork. Exhaust is provided in restrooms on each floor to remove odors and to maintain a slightly positive building pressurization.

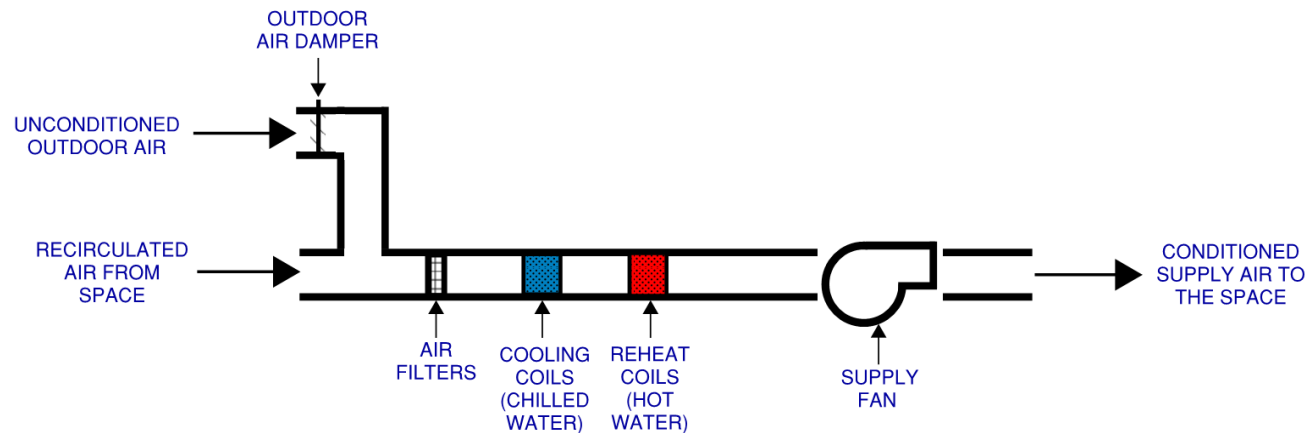

**SINGLE ZONE AIR HANDLING UNIT SCHEMATIC**

FAN COIL UNITS (FCUs)- A fan coil unit is fairly simple: it's a fan with a coil or coils (like a car radiator) that can add heating and cooling to the air stream flowing through it. The FCUs in old Peabody Hall have air filters to remove particulate matter from the air, a hot water coil and chilled water coil for heating and cooling the air, and a supply fan for forced air circulation through the unit and into the space. The coils provide heat transfer from building circulated heating hot water and chilled water with in the fan coil unit. Fan Coil Units in Park Hall generally have no ductwork and are visible in the space they serve, located against walls and below windows where possible. Each FCU is dedicated to a single room and recirculates the air within that space.

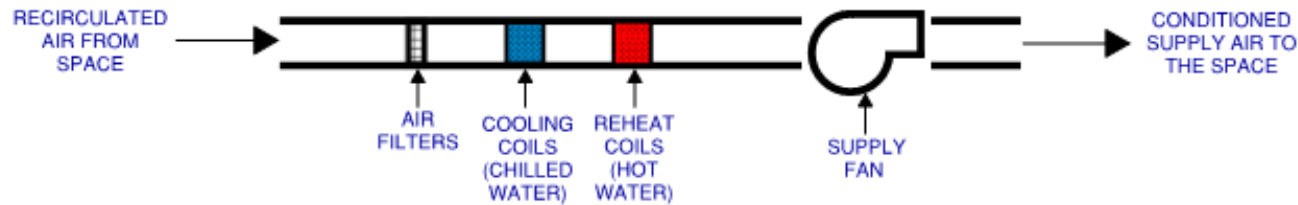

**4-PIPE FAN COIL UNIT SCHEMATIC**

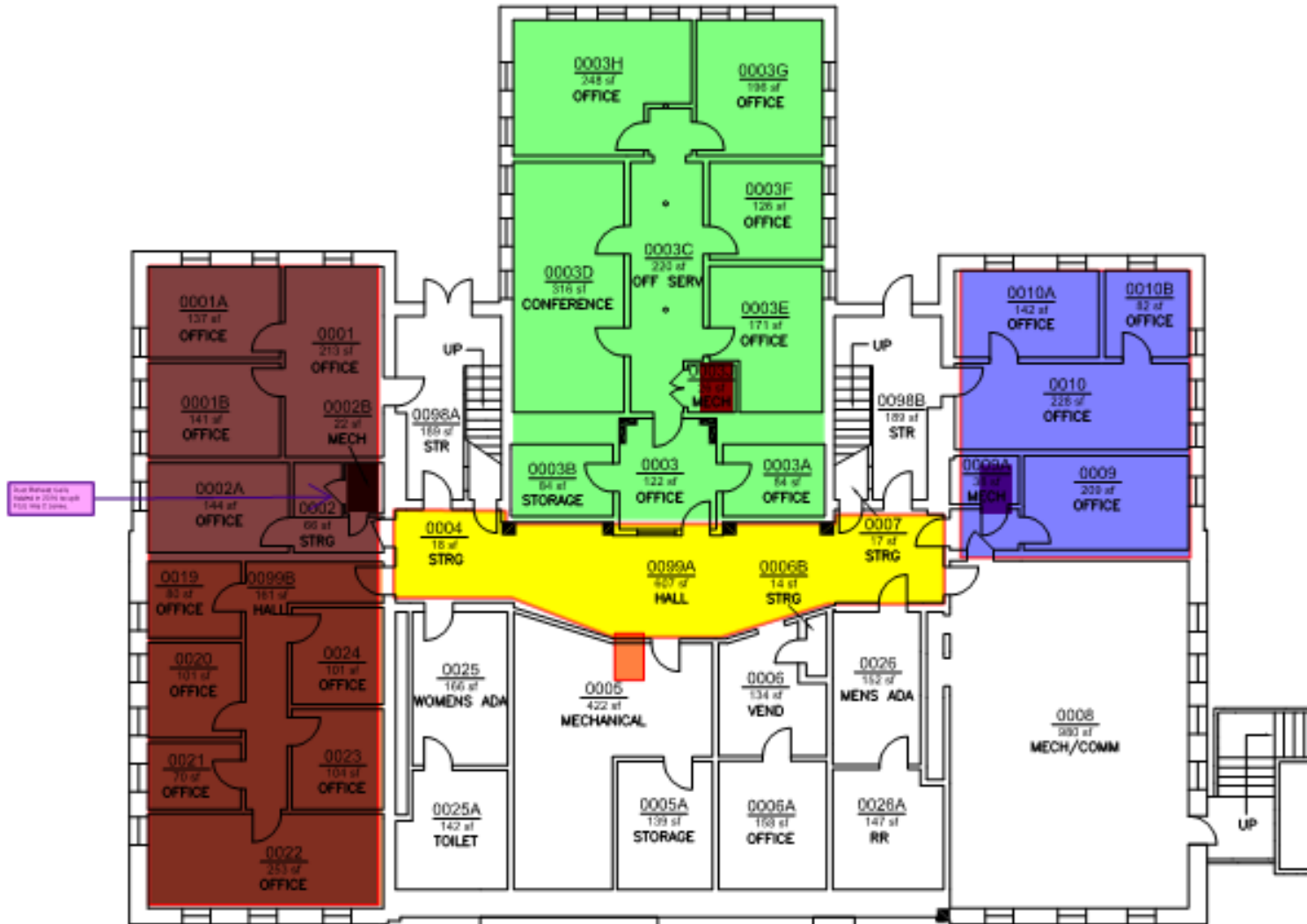

Blue Mechanical Units  
 Located in 0002, 0003, 0009, 0010, 0010A, 0010B, 0009A, 0009B, 0009C, 0009D, 0009E, 0009F, 0009G, 0009H, 0009I, 0009J, 0009K, 0009L, 0009M, 0009N, 0009O, 0009P, 0009Q, 0009R, 0009S, 0009T, 0009U, 0009V, 0009W, 0009X, 0009Y, 0009Z, 0009AA, 0009AB, 0009AC, 0009AD, 0009AE, 0009AF, 0009AG, 0009AH, 0009AI, 0009AJ, 0009AK, 0009AL, 0009AM, 0009AN, 0009AO, 0009AP, 0009AQ, 0009AR, 0009AS, 0009AT, 0009AU, 0009AV, 0009AW, 0009AX, 0009AY, 0009AZ, 0009BA, 0009BB, 0009BC, 0009BD, 0009BE, 0009BF, 0009BG, 0009BH, 0009BI, 0009BJ, 0009BK, 0009BL, 0009BM, 0009BN, 0009BO, 0009BP, 0009BQ, 0009BR, 0009BS, 0009BT, 0009BU, 0009BV, 0009BW, 0009BX, 0009BY, 0009BZ, 0009CA, 0009CB, 0009CC, 0009CD, 0009CE, 0009CF, 0009CG, 0009CH, 0009CI, 0009CJ, 0009CK, 0009CL, 0009CM, 0009CN, 0009CO, 0009CP, 0009CQ, 0009CR, 0009CS, 0009CT, 0009CU, 0009CV, 0009CW, 0009CX, 0009CY, 0009CZ, 0009DA, 0009DB, 0009DC, 0009DD, 0009DE, 0009DF, 0009DG, 0009DH, 0009DI, 0009DJ, 0009DK, 0009DL, 0009DM, 0009DN, 0009DO, 0009DP, 0009DQ, 0009DR, 0009DS, 0009DT, 0009DU, 0009DV, 0009DW, 0009DX, 0009DY, 0009DZ, 0009EA, 0009EB, 0009EC, 0009ED, 0009EE, 0009EF, 0009EG, 0009EH, 0009EI, 0009EJ, 0009EK, 0009EL, 0009EM, 0009EN, 0009EO, 0009EP, 0009EQ, 0009ER, 0009ES, 0009ET, 0009EU, 0009EV, 0009EW, 0009EX, 0009EY, 0009EZ, 0009FA, 0009FB, 0009FC, 0009FD, 0009FE, 0009FF, 0009FG, 0009FH, 0009FI, 0009FJ, 0009FK, 0009FL, 0009FM, 0009FN, 0009FO, 0009FP, 0009FQ, 0009FR, 0009FS, 0009FT, 0009FU, 0009FV, 0009FW, 0009FX, 0009FY, 0009FZ, 0009GA, 0009GB, 0009GC, 0009GD, 0009GE, 0009GF, 0009GG, 0009GH, 0009GI, 0009GJ, 0009GK, 0009GL, 0009GM, 0009GN, 0009GO, 0009GP, 0009GQ, 0009GR, 0009GS, 0009GT, 0009GU, 0009GV, 0009GW, 0009GX, 0009GY, 0009GZ, 0009HA, 0009HB, 0009HC, 0009HD, 0009HE, 0009HF, 0009HG, 0009HH, 0009HI, 0009HJ, 0009HK, 0009HL, 0009HM, 0009HN, 0009HO, 0009HP, 0009HQ, 0009HR, 0009HS, 0009HT, 0009HU, 0009HV, 0009HW, 0009HX, 0009HY, 0009HZ, 0009IA, 0009IB, 0009IC, 0009ID, 0009IE, 0009IF, 0009IG, 0009IH, 0009II, 0009IJ, 0009IK, 0009IL, 0009IM, 0009IN, 0009IO, 0009IP, 0009IQ, 0009IR, 0009IS, 0009IT, 0009IU, 0009IV, 0009IW, 0009IX, 0009IY, 0009IZ, 0009JA, 0009JB, 0009JC, 0009JD, 0009JE, 0009JF, 0009JG, 0009JH, 0009JI, 0009JJ, 0009JK, 0009JL, 0009JM, 0009JN, 0009JO, 0009JP, 0009JQ, 0009JR, 0009JS, 0009JT, 0009JU, 0009JV, 0009JW, 0009JX, 0009JY, 0009JZ, 0009KA, 0009KB, 0009KC, 0009KD, 0009KE, 0009KF, 0009KG, 0009KH, 0009KI, 0009KJ, 0009KK, 0009KL, 0009KM, 0009KN, 0009KO, 0009KP, 0009KQ, 0009KR, 0009KS, 0009KT, 0009KU, 0009KV, 0009KW, 0009KX, 0009KY, 0009KZ, 0009LA, 0009LB, 0009LC, 0009LD, 0009LE, 0009LF, 0009LG, 0009LH, 0009LI, 0009LJ, 0009LK, 0009LL, 0009LM, 0009LN, 0009LO, 0009LP, 0009LQ, 0009LR, 0009LS, 0009LT, 0009LU, 0009LV, 0009LW, 0009LX, 0009LY, 0009LZ, 0009MA, 0009MB, 0009MC, 0009MD, 0009ME, 0009MF, 0009MG, 0009MH, 0009MI, 0009MJ, 0009MK, 0009ML, 0009MM, 0009MN, 0009MO, 0009MP, 0009MQ, 0009MR, 0009MS, 0009MT, 0009MU, 0009MV, 0009MW, 0009MX, 0009MY, 0009MZ, 0009NA, 0009NB, 0009NC, 0009ND, 0009NE, 0009NF, 0009NG, 0009NH, 0009NI, 0009NJ, 0009NK, 0009NL, 0009NM, 0009NN, 0009NO, 0009NP, 0009NQ, 0009NR, 0009NS, 0009NT, 0009NU, 0009NV, 0009NW, 0009NX, 0009NY, 0009NZ, 0009OA, 0009OB, 0009OC, 0009OD, 0009OE, 0009OF, 0009OG, 0009OH, 0009OI, 0009OJ, 0009OK, 0009OL, 0009OM, 0009ON, 0009OO, 0009OP, 0009OQ, 0009OR, 0009OS, 0009OT, 0009OU, 0009OV, 0009OW, 0009OX, 0009OY, 0009OZ, 0009PA, 0009PB, 0009PC, 0009PD, 0009PE, 0009PF, 0009PG, 0009PH, 0009PI, 0009PJ, 0009PK, 0009PL, 0009PM, 0009PN, 0009PO, 0009PP, 0009PQ, 0009PR, 0009PS, 0009PT, 0009PU, 0009PV, 0009PW, 0009PX, 0009PY, 0009PZ, 0009QA, 0009QB, 0009QC, 0009QD, 0009QE, 0009QF, 0009QG, 0009QH, 0009QI, 0009QJ, 0009QK, 0009QL, 0009QM, 0009QN, 0009QO, 0009QP, 0009QQ, 0009QR, 0009QS, 0009QT, 0009QU, 0009QV, 0009QW, 0009QX, 0009QY, 0009QZ, 0009RA, 0009RB, 0009RC, 0009RD, 0009RE, 0009RF, 0009RG, 0009RH, 0009RI, 0009RJ, 0009RK, 0009RL, 0009RM, 0009RN, 0009RO, 0009RP, 0009RQ, 0009RR, 0009RS, 0009RT, 0009RU, 0009RV, 0009RW, 0009RX, 0009RY, 0009RZ, 0009SA, 0009SB, 0009SC, 0009SD, 0009SE, 0009SF, 0009SG, 0009SH, 0009SI, 0009SJ, 0009SK, 0009SL, 0009SM, 0009SN, 0009SO, 0009SP, 0009SQ, 0009SR, 0009SS, 0009ST, 0009SU, 0009SV, 0009SW, 0009SX, 0009SY, 0009SZ, 0009TA, 0009TB, 0009TC, 0009TD, 0009TE, 0009TF, 0009TG, 0009TH, 0009TI, 0009TJ, 0009TK, 0009TL, 0009TM, 0009TN, 0009TO, 0009TP, 0009TQ, 0009TR, 0009TS, 0009TT, 0009TU, 0009TV, 0009TW, 0009TX, 0009TY, 0009TZ, 0009UA, 0009UB, 0009UC, 0009UD, 0009UE, 0009UF, 0009UG, 0009UH, 0009UI, 0009UJ, 0009UK, 0009UL, 0009UM, 0009UN, 0009UO, 0009UP, 0009UQ, 0009UR, 0009US, 0009UT, 0009UU, 0009UV, 0009UW, 0009UX, 0009UY, 0009UZ, 0009VA, 0009VB, 0009VC, 0009VD, 0009VE, 0009VF, 0009VG, 0009VH, 0009VI, 0009VJ, 0009VK, 0009VL, 0009VM, 0009VN, 0009VO, 0009VP, 0009VQ, 0009VR, 0009VS, 0009VT, 0009VU, 0009VV, 0009VW, 0009VX, 0009VY, 0009VZ, 0009WA, 0009WB, 0009WC, 0009WD, 0009WE, 0009WF, 0009WG, 0009WH, 0009WI, 0009WJ, 0009WK, 0009WL, 0009WM, 0009WN, 0009WO, 0009WP, 0009WQ, 0009WR, 0009WS, 0009WT, 0009WU, 0009WV, 0009WW, 0009WX, 0009WY, 0009WZ, 0009XA, 0009XB, 0009XC, 0009XD, 0009XE, 0009XF, 0009XG, 0009XH, 0009XI, 0009XJ, 0009XK, 0009XL, 0009XM, 0009XN, 0009XO, 0009XP, 0009XQ, 0009XR, 0009XS, 0009XT, 0009XU, 0009XV, 0009XW, 0009XX, 0009XY, 0009XZ, 0009YA, 0009YB, 0009YC, 0009YD, 0009YE, 0009YF, 0009YG, 0009YH, 0009YI, 0009YJ, 0009YK, 0009YL, 0009YM, 0009YN, 0009YO, 0009YP, 0009YQ, 0009YR, 0009YS, 0009YT, 0009YU, 0009YV, 0009YW, 0009YX, 0009YY, 0009YZ, 0009ZA, 0009ZB, 0009ZC, 0009ZD, 0009ZE, 0009ZF, 0009ZG, 0009ZH, 0009ZI, 0009ZJ, 0009ZK, 0009ZL, 0009ZM, 0009ZN, 0009ZO, 0009ZP, 0009ZQ, 0009ZR, 0009ZS, 0009ZT, 0009ZU, 0009ZV, 0009ZW, 0009ZX, 0009ZY, 0009ZZ

GROUND FLOOR HVAC ZONES

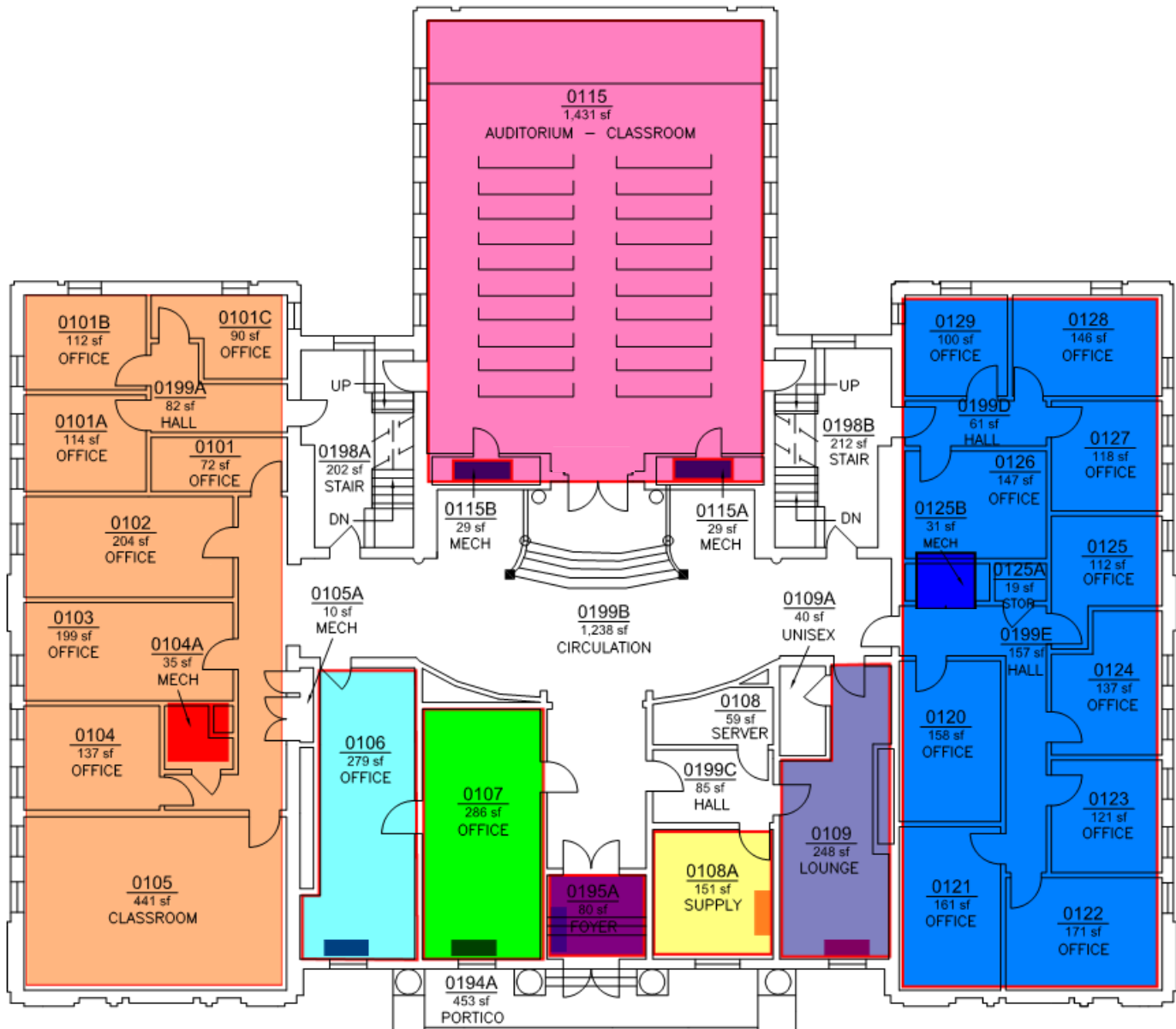

FIRST FLOOR HVAC ZONES

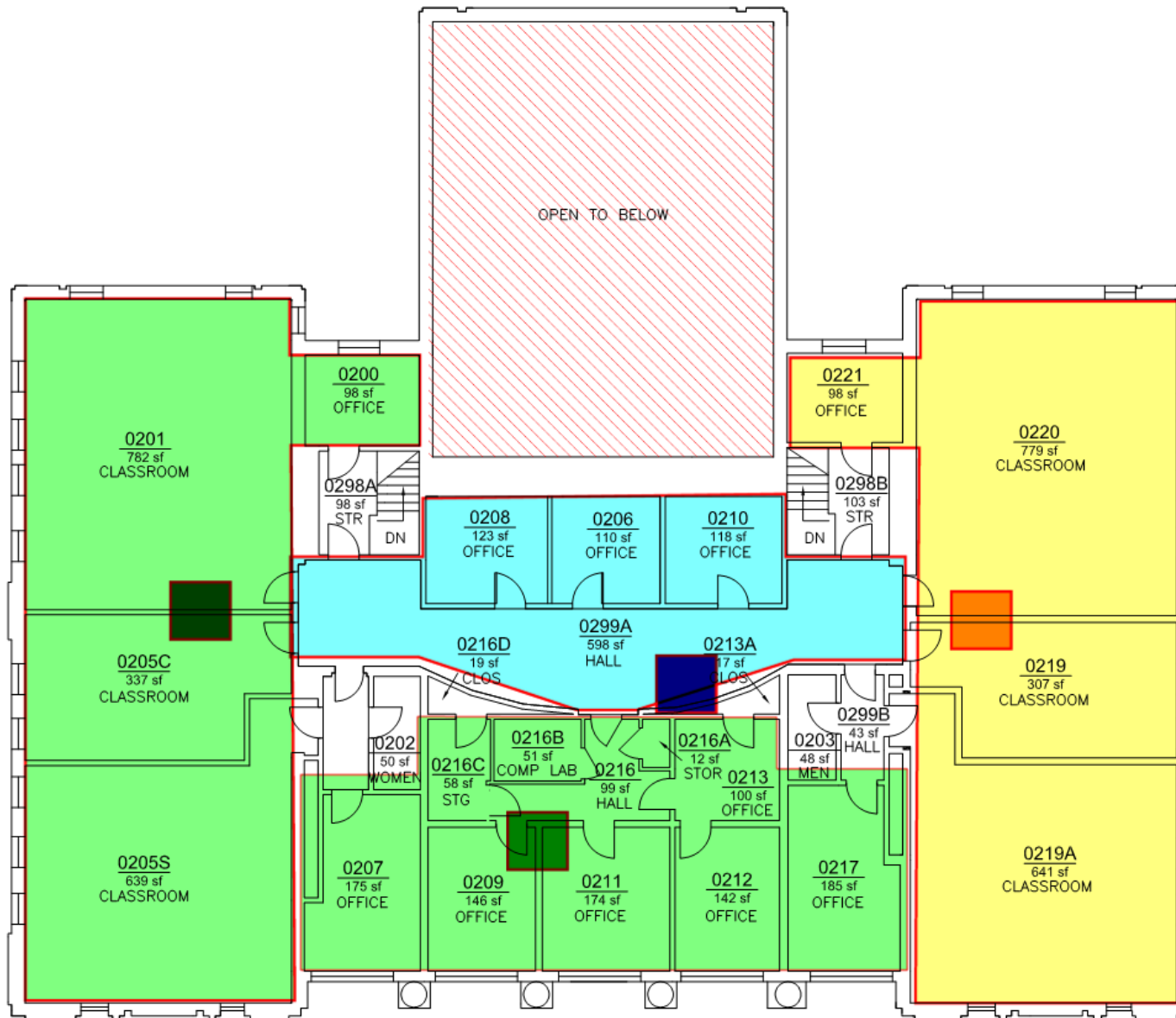

SECOND FLOOR HVAC ZONES